

Universal Joints proved a simple & economic method of connecting two shafts whose axes are inclined at an angle. They are also used when the angle varies during rotation eliminating the need for the complicated & expensive mechanisms usually associated with this type

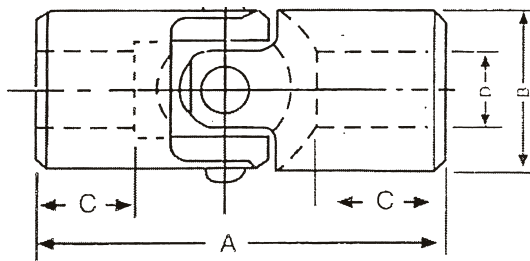

**SJ**

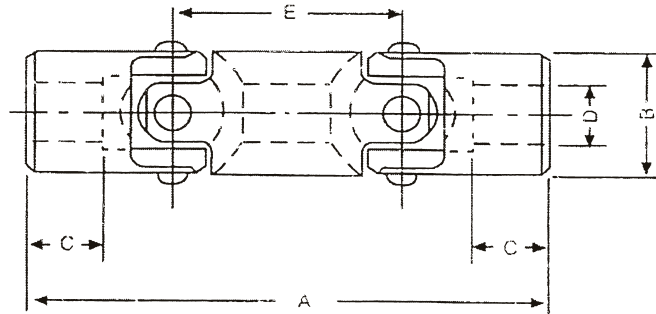

**DJ**

STATIC  
BREAKING  
TORQUE

STATIC  
BREAKING  
TORQUE

MODEL NO.	B	A	BORE SIZE		C	N.m.	MODEL NO.	B	A	BORE SIZE		C	E	N.m.
			STANDARD	WITH KEY WAY						STANDARD	WITH KEY WAY			
<b>SJ 1</b>	9.5	44	6	-	13	21	<b>DJ 1</b>	13	71.5	8	-	15	21	44
<b>SJ 2</b>	13	50	8	-	15	44	<b>DJ 2</b>	16	81	10	7.5	16	25	75
<b>SJ 3</b>	16	58	10	7.5	17	75	<b>DJ 3</b>	19	91	12	8.5	19	27	89
<b>SJ 4</b>	19	64	12	8.5	19	89	<b>DJ 4</b>	22.5	111	14	11	21	35	135
<b>SJ 5</b>	22.5	76	14	11	21	135	<b>DJ 5</b>	22.5	122	16	12	25	36	193
<b>SJ 6</b>	25.5	86	16	12	25	193	<b>DJ 6</b>	29	133	18	14	26	43	331
<b>SJ 7</b>	29	90	18	14	26	331	<b>DJ 7</b>	32	143	20/22	16	26.5	48	600
<b>SJ 8</b>	32	95	20/22	16	26.5	600	<b>DJ 8</b>	38.5	162	25	19	30	54	910
<b>SJ 9</b>	38.5	108	25	19	30	910	<b>DJ 9</b>	44.5	194	30	22.5	34.5	67	1230
<b>SJ 10</b>	44.5	127	30	22.5	34.5	1230	<b>DJ 10</b>	51	218	35	27.5	38	78	1790
<b>SJ 11</b>	51	140	35	27.5	38	790	<b>DJ 11</b>	57.5	245	40	32	47.5	80	2850
<b>SJ 12</b>	57.5	165	50	32	47.5	2860	<b>DJ 12</b>	63.5	264	45	36.5	50	89	3810
<b>SJ 13</b>	63.5	178	45	36.5	50	3810	<b>DJ 13</b>	76.5	318	50	44.5	56	96	7510
<b>SJ 14</b>	76.5	222	50	44.5	66	7510	<b>DJ 14</b>	89	365	65	53	78	111	11010
<b>SJ 15</b>	89	254	65	53	78.5	11010	<b>DJ 15</b>	102	410	70	62	94	118	15850
<b>SJ 16</b>	102	292	70	62	94	15850	-	-	-	-	-	-	-	-

All Dimensions in MM

## B.V. Transmission Industries

Unit 18 , Khyati Industrial Estate,  
Laxmi Nagar, Link Road , Goregaon West,  
Mumbai - 400104, Maharashtra , India

Tel : +91- 22-28762345  
Tel : +91- 22-28767941  
☎ : +91- 93247 18035  
☎ : +91- 98206 92004

email :: sales@bvchains.com  
bvchain@gmail.com  
web:: www.bvchains.com